

ISO TUBI

STAINLESS STEEL
PIPES AND FITTINGS

PRODUCT CATALOGUE
STAINLESS STEEL TUBES AND FITTINGS



BIGPRESS

139,7 mm (DN 125)

168,3 mm (DN 150)

S = 2 / 2,6 mm **DNV**
AISI 316L (MAT. 1.4404)

AVAILABLE SINCE 2010



INDEX

STAINLESS STEEL TUBES AND FITTINGS

BIGPRESS



4

MAIN PRESSFITTINGS TOOLS

9

APPLICATIONS

10

*Please refer to our website for the latest edition

FIG.1



MAT. AISI 316L

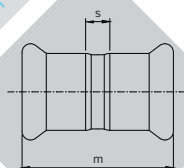
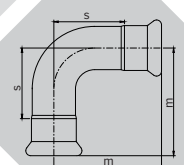

FIG.3



MAT. AISI 316L



COUPLING

Dimensions	m	s	Pieces/Bag	Art. Nr.
139.7	250	54	1	F0113926
139.7	250	54	1	F011392.66 DVGW
168.3	300	64	1	F0116826
168.3	300	64	1	F011682.66 DVGW

90° F-F ELBOW

Dimensions	m	s	Pieces/Bag	Art. Nr.
139.7	314	216	1	F0313926
139.7	314	216	1	F031392.66 DVGW
168.3	386	268	1	F0316826
168.3	386	268	1	F031682.66 DVGW



BIGPRESS

FIG.4



MAT: AISI 316L

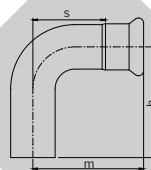
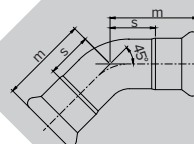

FIG.5



MAT: AISI 316L



90° M-F ELBOW

	Dimensions	m	h	s	Pieces/Bag	Art. Nr.
	139.7	314	322	216	1	F0413926
DVGW	139.7	314	322	216	1	F041392.66
	168.3	386	404	268	1	F0416826
DVGW	168.3	386	404	268	1	F041682.66

45° F-F ELBOW

	Dimensions	m	s	Pieces/Bag	Art. Nr.
	139.7	203	105	1	F0513926
DVGW	139.7	203	105	1	F051392.66
	168.3	252	134	1	F0516826
DVGW	168.3	252	134	1	F051682.66

FIG.6



MAT: AISI 316L

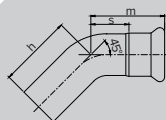

45° M-F ELBOW

Dimensions	m	h	s	Pieces/Bag	Art. Nr.
139.7	203	210	105	1	F0613926
139.7	203	210	105	1	F061392.66 DVGW
168.3	252	253	134	1	F0616826
168.3	252	253	134	1	F061682.66 DVGW

FIG.12

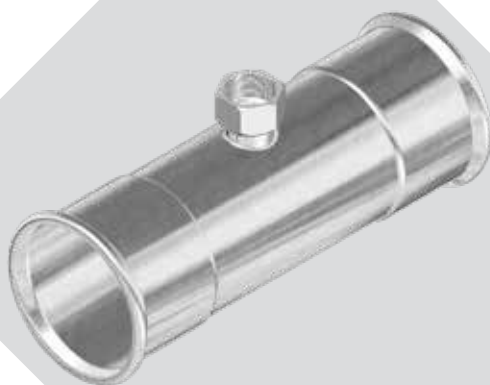

MAT: AISI 316L

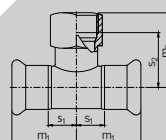

F TEE THREADED ADAPTOR

Dimensions	m ₁	m ₂	s ₁	s ₂	Pieces/Bag	Art. Nr.
139.7-1/2-139.7	197	100,5	99	87,5	1	F121391/213926
139.7-1/2-139.7	197	100,5	99	87,5	1	F121391/22.66 DVGW
139.7-1 1/4-139.7	197	110,5	99	91,5	1	F1213911/42.66 DVGW
139.7-2"-139.7	197	123	99	94	1	F12139266
139.7-2"-139.7	197	123	99	94	1	F1213922.66 DVGW
139.7-3/4-139.7	197	105,5	99	90,5	1	F121393/426
139.7-3/4-139.7	197	105,5	99	90,5	1	F121393/42.66 DVGW
168.3-1 1/4-168.3	257	125	139	106	1	F1216811/426
168.3-1 1/4-168.3	257	125	139	106	1	F1216811/42.66 DVGW
168.3-3/4-168.3	257	120	139	105	1	F121683/416826
168.3-3/4-168.3	257	120	139	105	1	F121683/42.66 DVGW
168.3-2"-168.3	257	138	139	109	1	F1216826
168.3-2"-168.3	257	138	139	109	1	F1216822.66 DVGW



MF REDUCER

	Dimensions	m	s	Pieces/Bag	Art. Nr.
	139.7-88.9	340	282	1	F141398826
DVGW	139.7-88.9	340	282	1	F14139882.66
	139.7-108	307	236	1	F1413910826
DVGW	139.7-108	307	236	1	F141391082.66
	168.3-88.9	379	321	1	F141688826
DVGW	168.3-88.9	379	321	1	F14168882.66
	168.3-108	360	289	1	F1416810826
DVGW	168.3-108	360	289	1	F141681082.66
	168.3-139.7	422	324	1	F1416813926
DVGW	168.3-139.7	422	324	1	F141681392.66

FIG.14



MAT: AISI 316L

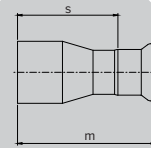

REDUCING TEE

	Dimensions	m ₁	m ₂	s ₁	s ₂	Pieces/Bag	Art. Nr.
	139.7-76.1-139.7	197	143	99	88	1	F151397613926
DVGW	139.7-76.1-139.7	197	143	99	88	1	F15139761392.66
	139.7-88.9-139.7	197	153	99	95	1	F151398813926
DVGW	139.7-88.9-139.7	197	153	99	95	1	F15139881392.66
	139.7-108-139.7	197	167	99	96	1	F1513910813926
DVGW	139.7-108-139.7	197	167	99	96	1	F151391081392.66
	168.3-76.1-168.3	257	157	139	103	1	F151687616826
DVGW	168.3-76.1-168.3	257	157	139	103	1	F15168761682.66
	168.3-88.9-168.3	257	167	139	110	1	F151688816826
DVGW	168.3-88.9-168.3	257	167	139	110	1	F15168881682.66
	168.3-108-168.3	257	182	139	111	1	F1516810816826
DVGW	168.3-108-168.3	257	182	139	111	1	F151681081682.66
	168.3-139.7-168.3	257	211	139	113	1	F1516813916826
DVGW	168.3-139.7-168.3	257	211	139	113	1	F151681391682.66

FIG.15



MAT: AISI 316L

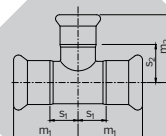
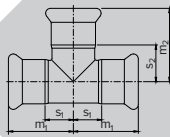

FIG.16



MAT: AISI 316L



EQUAL TEE

Dimensions	m ₁	m ₂	s ₁	s ₂	Pieces/ Bag	Art. Nr.
139.7	197	197	99	99	1	F1613926
139.7	197	197	99	99	1	F161392.66 DVGW
168.3	257	235	139	118	1	F1616826
168.3	257	235	139	118	1	F161682.66 DVGW

FIG.28

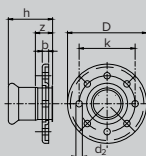

PRESS FLANGED ADAPTOR

Dimensions	D	k	b	d ₂	h	n*	z	Pieces/ Bag	Art. Nr.
139.7-DN 125	250	210	22	18	138	8	41	1	F2813926
139.7-DN 125	250	210	22	18	138	8	41	1	F281392.66 DVGW
168.3-DN 150	285	240	24	22	171	8	54	1	F2816826
168.3-DN 150	285	240	24	22	171	8	54	1	F281682.66 DVGW

MAIN PRESSFITTING TOOLS



BIGPRESS



novopress

ACO 401/403



"How to press" video

	ACO 401	ACO 403
Battery	18 V / 3 Ah	18 V / 3 Ah
Battery capacity	15-20 pressing cycles	20-30 pressing cycles
Power	400 W	450 W
Dimensions	650 x 95 x 320 mm	650 x 95 x 320 mm
Weight	13 Kg	13 Kg
Piston force	100 kN	120 kN

With a pressing force of 100 - 120 kN and a working stroke of 60 mm, the pressing unit provides sufficient energy for special applications with larger pipe dimensions. Sprinkler installations, fire-extinguishing systems or special industrial systems with dimensions from 76.1 to 168.3 mm do not pose any problem for the press tool. Due to the powerful, rechargeable lithium-ion batteries. The innovative Brushless Motor Technology is impressive with its high performance and its low need for maintenance.

Thanks to the ergonomic handles, the unit lies safe in the hand, so that it is no problem to work even under a hall ceiling. Due to the rotatable head with a firmly mounted adaptor-jaw, the unit can be applied even at hardly accessible pressing points.

WELDED TUBES

Our welded stainless steel tubes are manufactured in accordance with the EN 10312 and EN 10.217-7 standards.

This meets the 1.4404/1.4301 AISI 316L/AISI 304 standard under UNE EN 10088.

The tubes comply with DVGW W541 specifications.

Dimensions	O.D. x wall thickness	O.D. x wall thickness
DN 125	139,7 x 2,6	139,7 x 2
DN 150	168,3 x 2,6	168,3 x 2

M profile jaws or collars should always be used.
In case of doubt, please ask our technical department.

NUMEPRESS FITTING:
with compression loop fitted





SYSTEM TECHNICAL SPECIFICATIONS

Joint type: O-ring resistant to hot water, ageing and the additives commonly used in drinking water. There are different kind of O-rings depending on its application.

Fitting material: Stainless steel n° 1.4404 (AISI 316L).
Characteristics:

- ◆ Hygienic, as demonstrated in many food and pharmaceutical industry applications.
- ◆ Minimum load loss, resulting in faster fluid flows.
- ◆ Excellent decorative finish avoiding need for additional painting or external protection costs.
- ◆ Less heat conduction than other materials.
- ◆ The use of molybdenum results in good performance in chlorinated environments.
- ◆ Good resistance to oxidation and good mechanical and deformation resistance at high temperatures.
- ◆ Environmentally friendly.

Joint type: Cold joint ideal for joining thinwall stainless steel pipes.

Working pressure: Max. 16 bar.

Working temperature:

- ◆ With EPDM O-ring (black) –20 °C to +110 °C
- ◆ With FKM O-ring (green) –20 °C to +200 °C
- ◆ With FKM O-ring (red) –10°C to +200 °C
- ◆ With HNBR O-ring (yellow) –20 °C a +70 °C

Wall-thickness of the fitting:

- ◆ 2 or 2.6 mm for diameters 139,7, 168,3

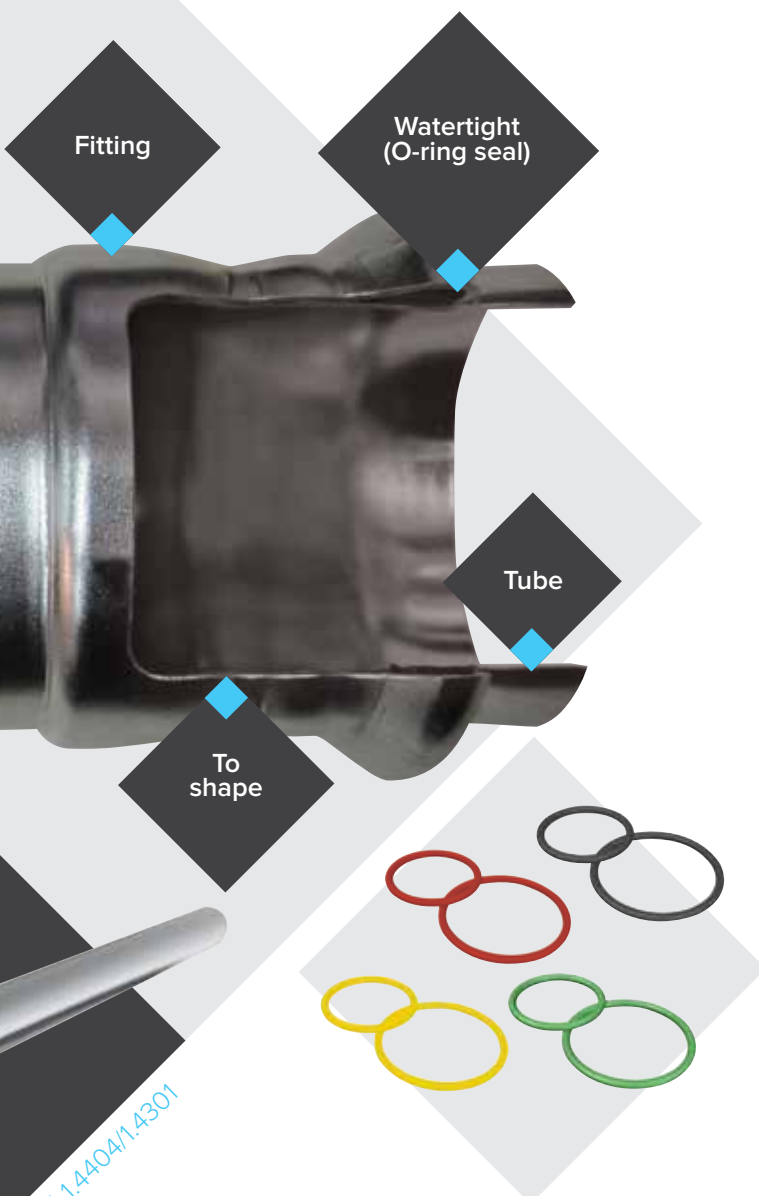

MAT. 1.4404/1.4301



ISO TUBI

Offices / Warehouse 1: Av. Can Campanyà, 15.
Pol. Ind. Compte de Sert
08755 Castellbisbal (Barcelona), Spain

Warehouse 2: C/Gibraltar, 12.
Pol. Ind. Fuente del Jarro
46988 Paterna (Valencia), Spain

Tel. + 34 93 771 16 97
isotubi@isotubi.com • www.isotubi.com

